

Easi-Glide fitting instructions



Please read and understand these instructions fully prior to starting installation. It is strongly recommended that a competent trades person installs this product.

Introduction

The Easi-Glide system can be used for Single and Double Door opening configurations.

The maximum door weight is 45kg each.

The system can be used for 35mm and 40mm thick doors. Thicker doors, up to 50mm, will require the Pelmet to be built out from the wall to allow the door to slide past the wall.

Door widths of between 610mm and 915mm can be used.

Single and Double Width Pelmets are supplied over-sized for on-site trimming to suit aperture and door width/s.

Ensure that the wall that the Easi-Glide system is fitted to is not obstructed by skirting boards, light fittings, etc.

Doors cannot be reduced in height from the top door edge lipping: The full lipping thickness is required on the top of the door for secure fixing of the Hanger Plates. The side and bottom lippings can be trimmed as per the door instructions.

Please ensure that you follow the finishing instructions supplied with the doors.

Storing, installing or finishing the product in a manner not detailed in the instructions may invalidate the warranty.

Prepare the opening

Ensure that the door(s) are of sufficient height and width to cover the Aperture when closed.

Calculate width of pelmet requirement and trim to suit the installation: The pelmet should extend at least 100mm beyond the aperture on the “door closed” side. The pelmet should extend beyond the aperture on the “door open” side by the width of the door plus 100mm.

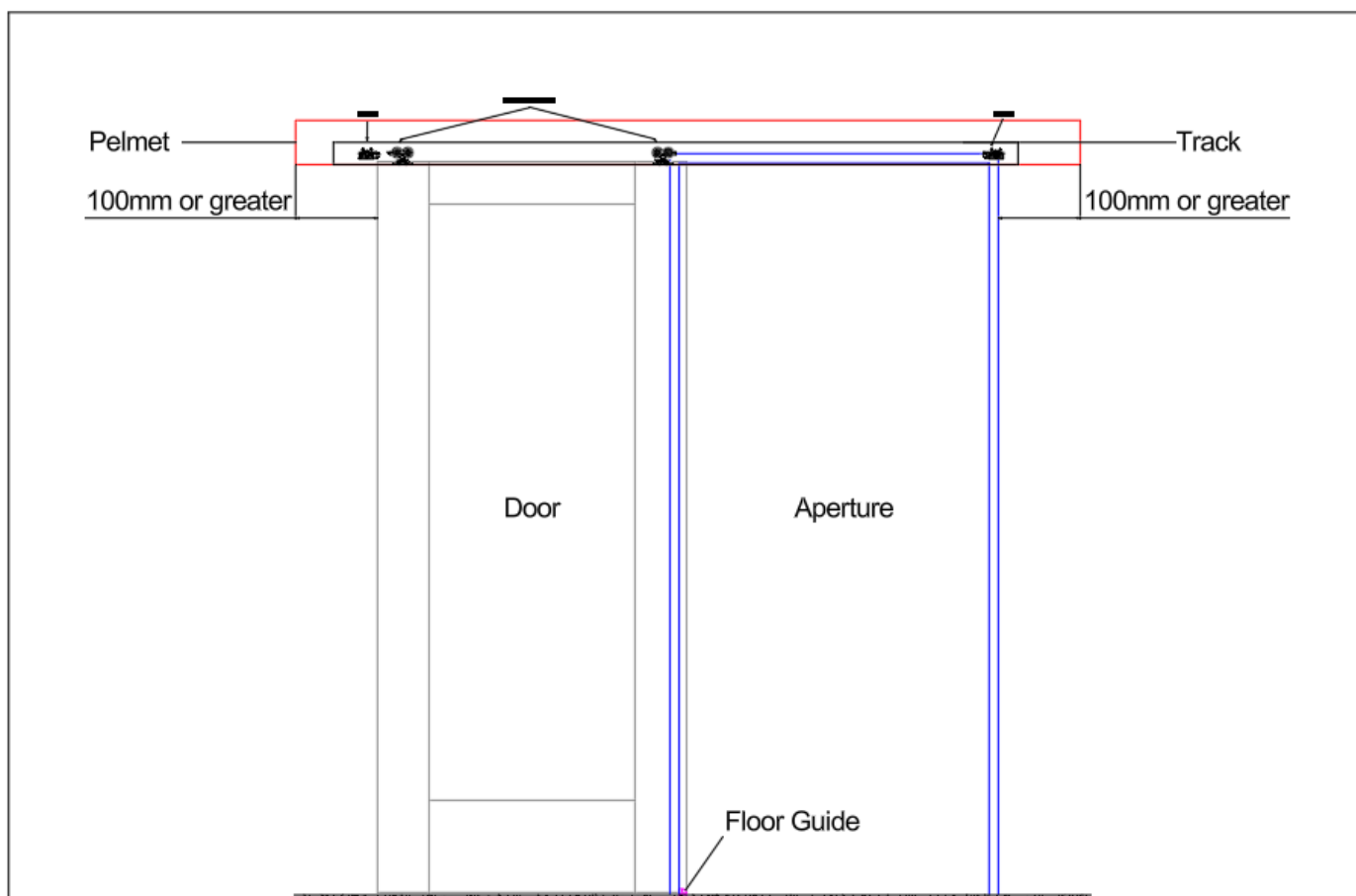

Fit the pelmet to the wall

Determine the track height required ensuring there is approximately 7mm between the floor and the bottom edge of the door and that the door covers the height of the aperture.

Ensure that the Pelmet is fixed to the wall using suitable screws.

Fix the track into the top of the pelmet (the track will require drilling 90mm from each end and approximately 250mm centres).

Fit the track to the pelmet

Fit the Track through its top horizontal edge into the underside of the Pelmet using 15mm screws.

The tracks can be trimmed to allow for narrow door installations: Allow sufficient track length for door(s) to open fully.

The Pelmet Fascia is delivered separately to allow Track and Pelmet fitting.

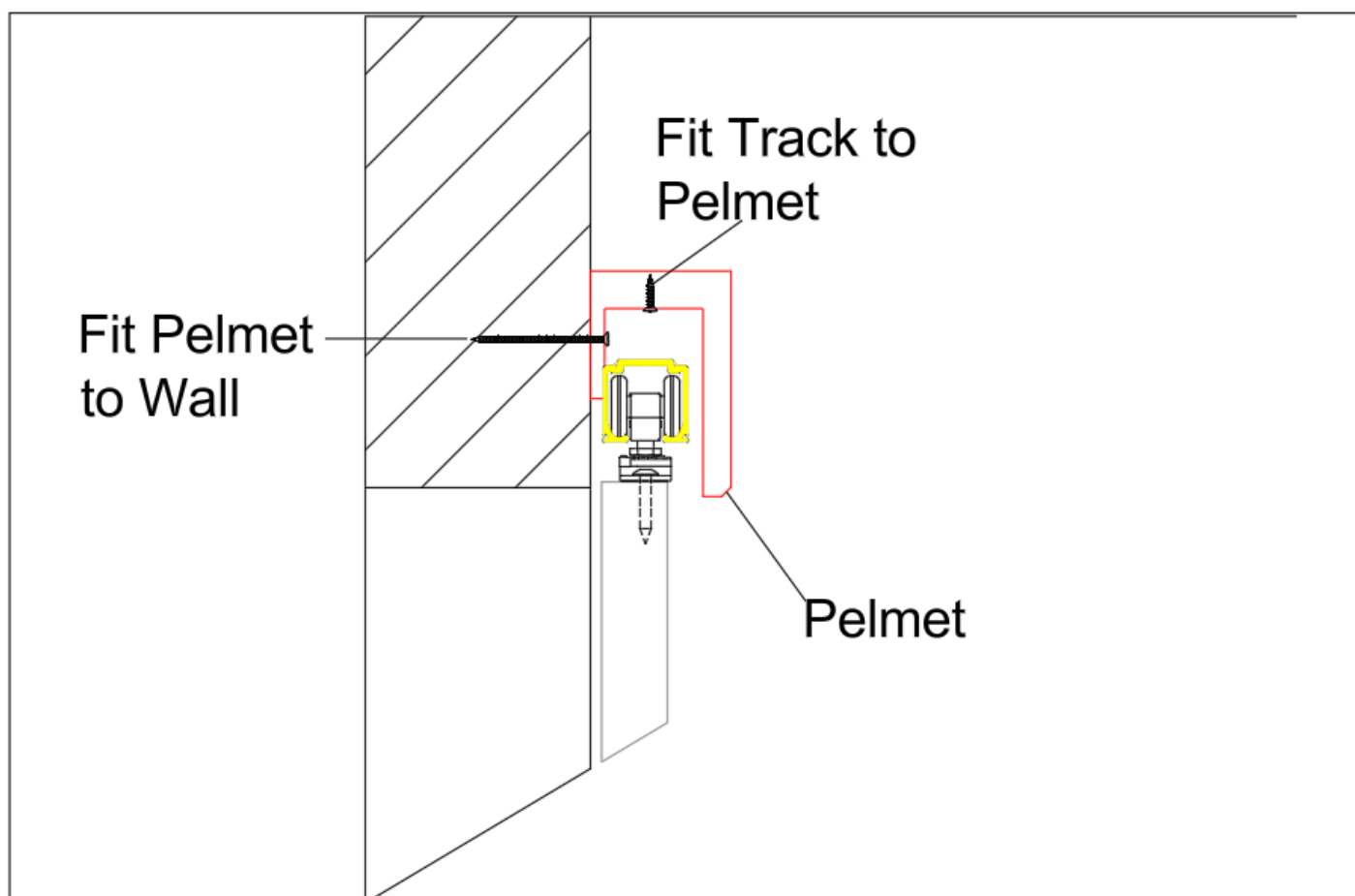

Fit the hangers to top edge of the door

Detach the carrier from the Bracket of the Plated 4 Wheel Carriers and fit the Brackets at either end of the top edge of the Sliding Door(s). The Brackets should be located 100mm from the edge of the stiles to the end of the Bracket. Pre-drill the screw holes prior to fixing.

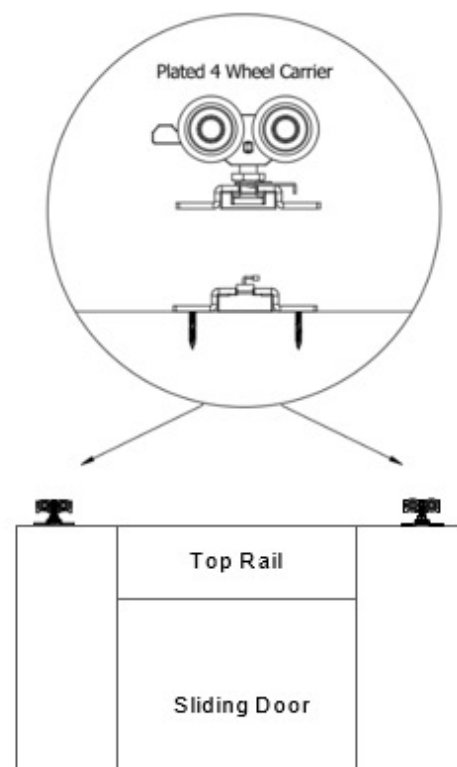

Hang the door onto the track

Place the Hangers onto the Track, correctly inserting the track hangers and clip stops.

Slot the Hanger bolts onto the Hanger Plates.

Adjust the Top Bolt until the bottom of the door is approximately 7mm from the floor.

Ensure that the door hangs level and can slide along the track smoothly – ensure that the door does not slide off the track.

Tighten the bolts to secure the door to the hanger.

Fit the floor guide to the floor

Fix the Floor Guide to the Aperture reveal where it intersects with the floor

Adjust the Floor Guide to the door thickness with approximately 2mm clearance and tighten

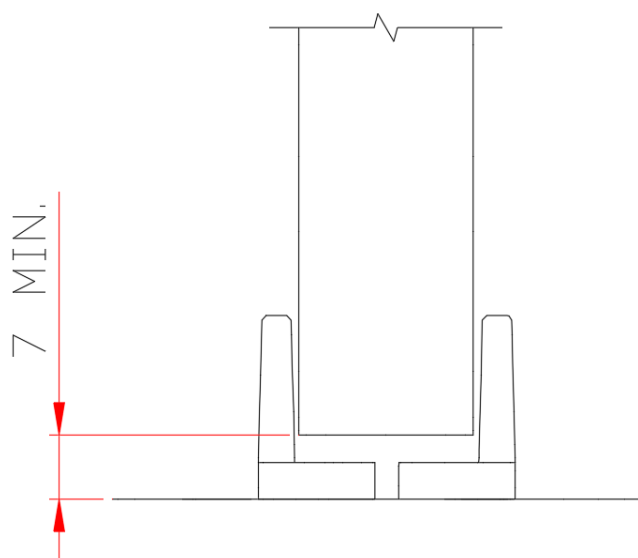

Adjust the clip stops

Adjust the clip stops to ensure the door fully opens and does not fall from the edge of the track.

Fit the fascia to the pelmet

After fitting the Pelmet to the wall and making any hardware adjustments, fit the Fascia to the Pelmet: Ensure that the Fascia is pre-drilled prior to screwing through the pre-drilled Pelmet.

Pelmet:
Fascia delivered unassembled for on-site installation after track fitted

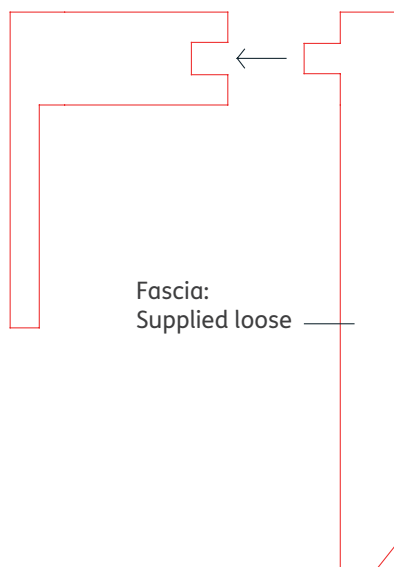

Assembled Pelmet:
Pre-drilled screw holes to fix pelmet fascia

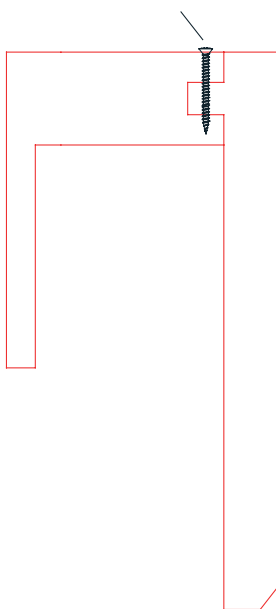

Pre-drilled
pelmet end caps
to fix to pelmet

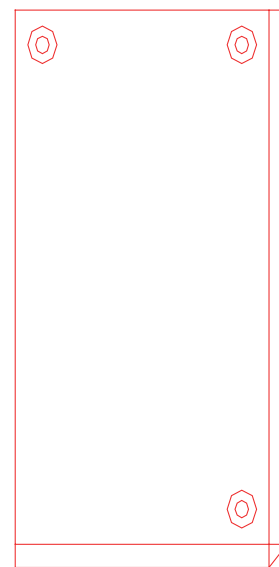

Fit the end caps to the pelmet and fascia

Once the Fascia has been fitted to the Pelmet, the End Caps should be screwed to the Pelmet Ends, pre-drilling through the pre-drilled End Caps first.